

Ventilation Louvres

A-3250 | Technical Datasheet



 www.c-sgroup.co.uk/21927

Ventilation Louvres

A-3250 | Technical Datasheet

STANDARD DETAIL

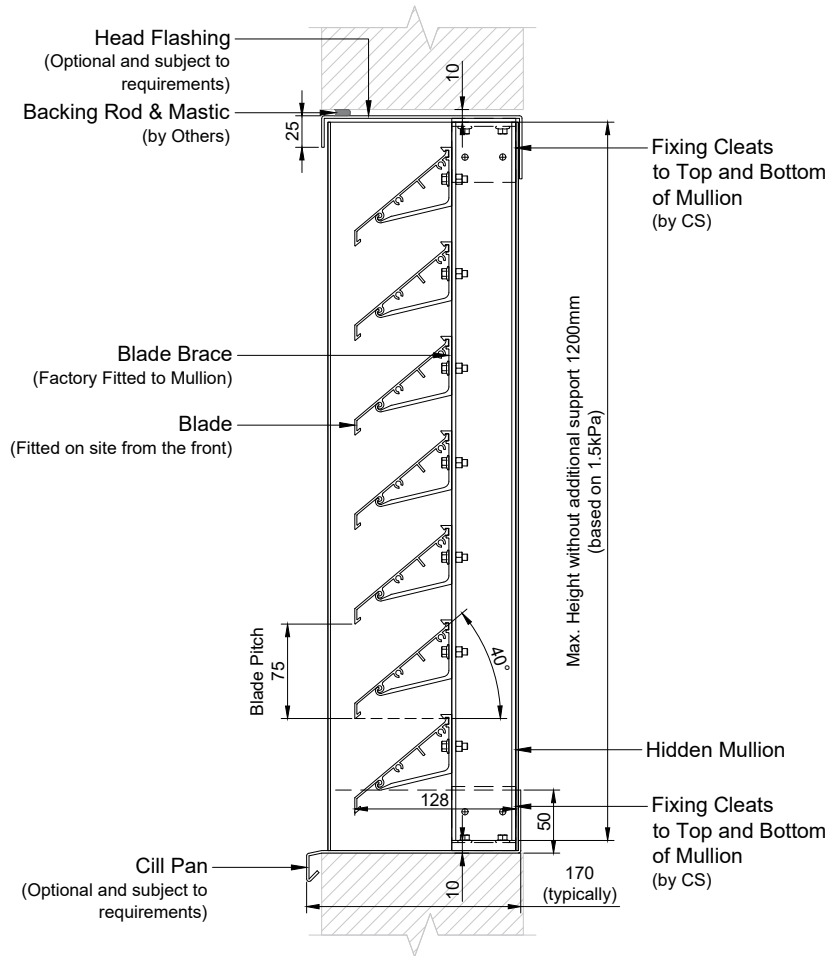

SECTION ON ELEVATION (1:6 @A4)

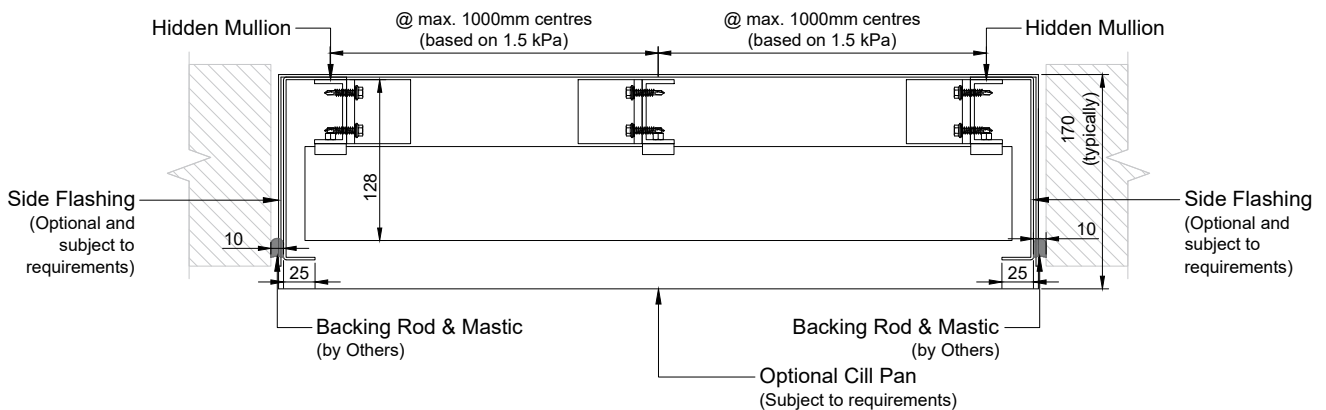

PLAN VIEW (1:6 @A4)

 www.c-sgroup.co.uk/21927

All dimensions in millimeters unless otherwise stated. Do not scale from the drawing.

Ventilation Louvres

A-3250 | Technical Datasheet

STANDARD DETAIL

Fixed to Steelwork by Others

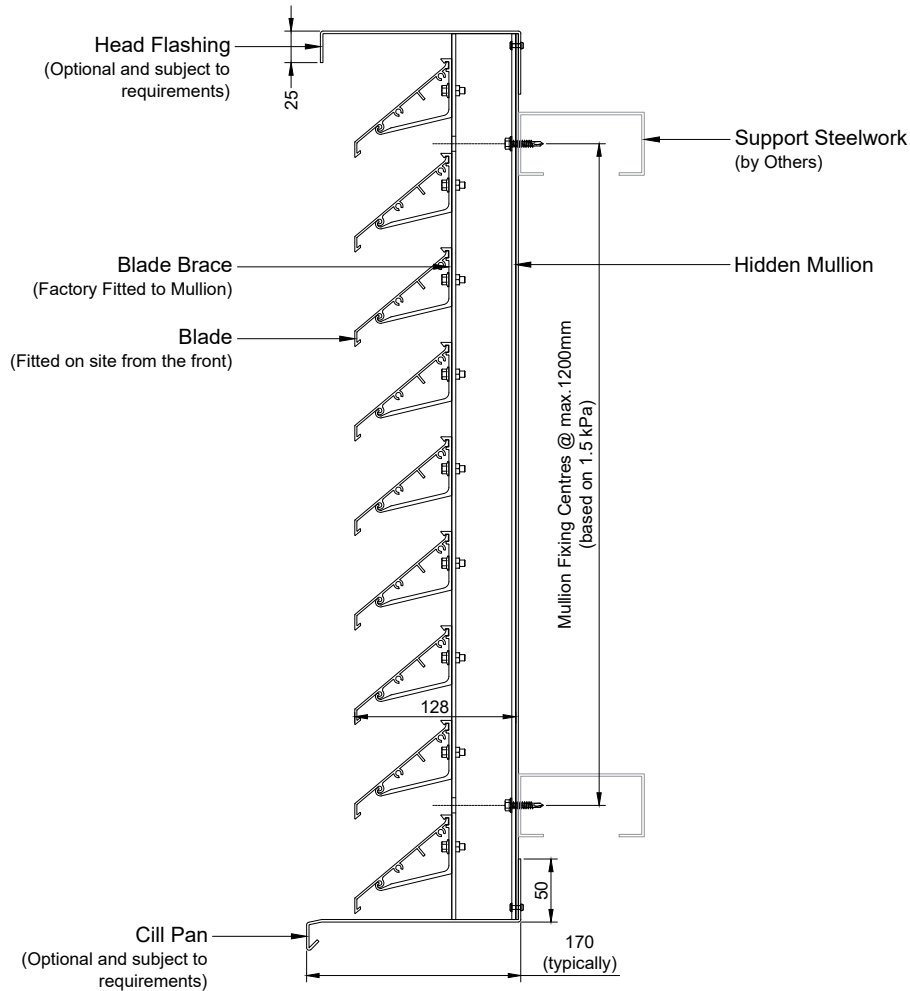

SECTION ON ELEVATION (1:6 @A4)

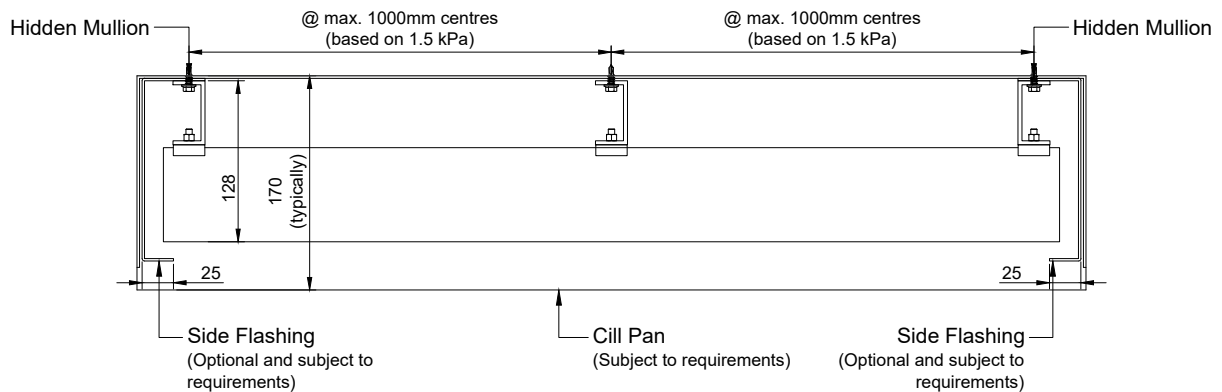

PLAN VIEW (1:6 @A4)

All dimensions in millimeters unless otherwise stated. Do not scale from the drawing.

Ventilation Louvres

A-3250 | Technical Datasheet

STANDARD DETAIL

With Insect Mesh or Bird Guard

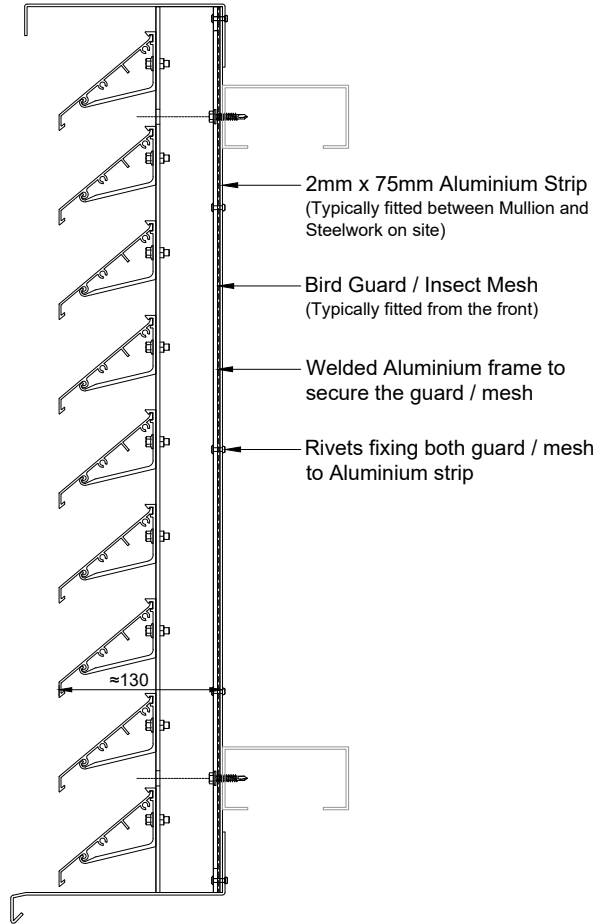

SECTION ON ELEVATION (1:6 @A4)

INSECT MESH

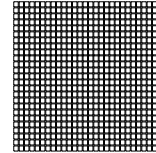

Fiberglass Mesh
Black PVC coated
(1:2 @A4)
LV-1008
72% Free Area

BIRD/ VERMIN GUARDS

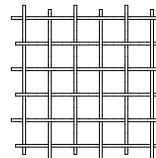

Galvanized Welded Mesh - (Standard)
(1:4 @A4)
LV-1408
85% Free Area

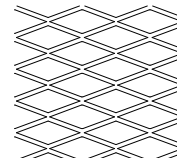

Flattened Aluminium
38-85AF - (Option)
(1:4 @A4)
LV-0158
73% Free Area

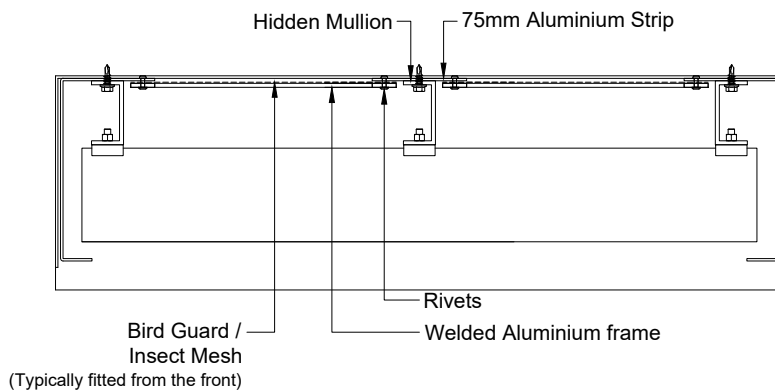

PLAN VIEW (1:6 @A4)

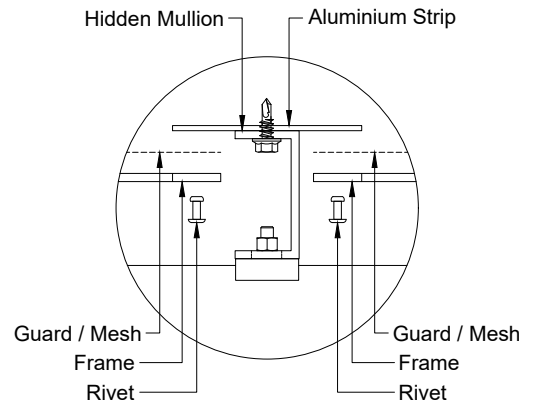

EXPLODED DETAIL

All dimensions in millimeters unless otherwise stated. Do not scale from the drawing.

Ventilation Louvres

A-3250 | Technical Datasheet

STANDARD DETAIL

With Single Skin Blanking Panel

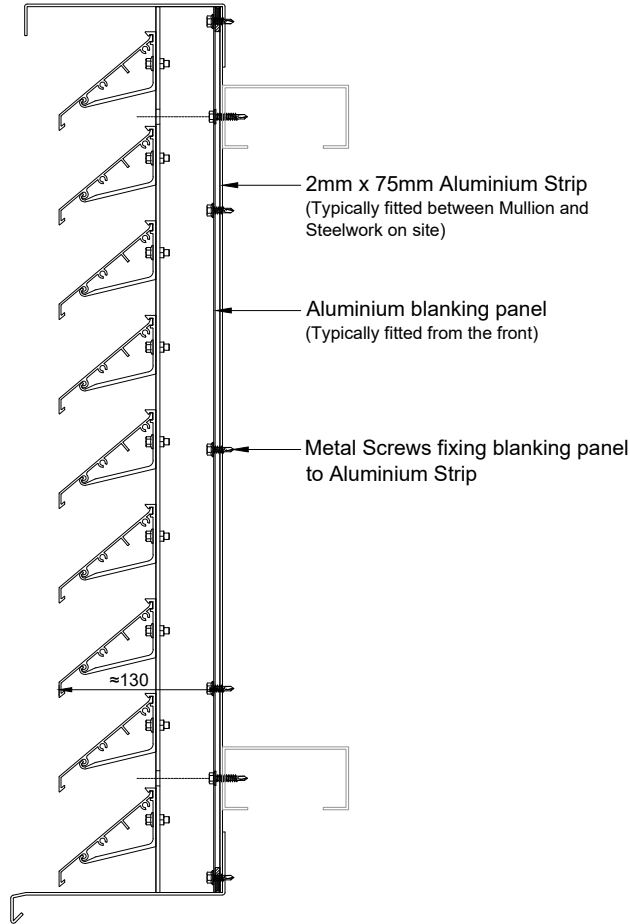

SECTION ON ELEVATION (1:6 @A4)

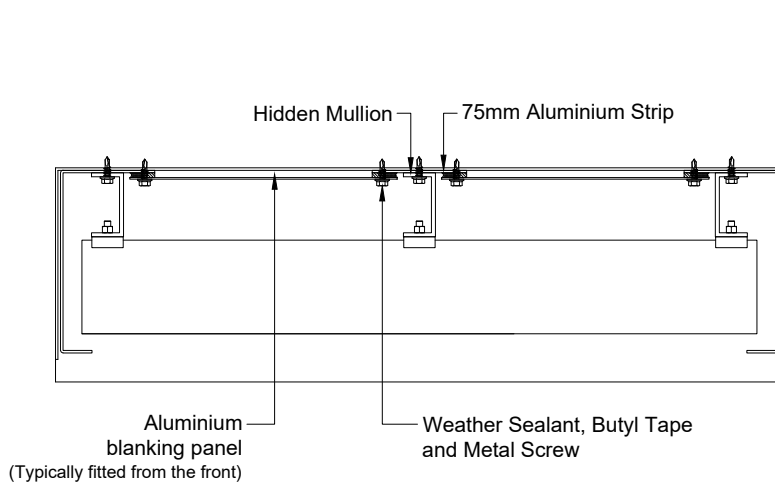

PLAN VIEW (1:6 @A4)

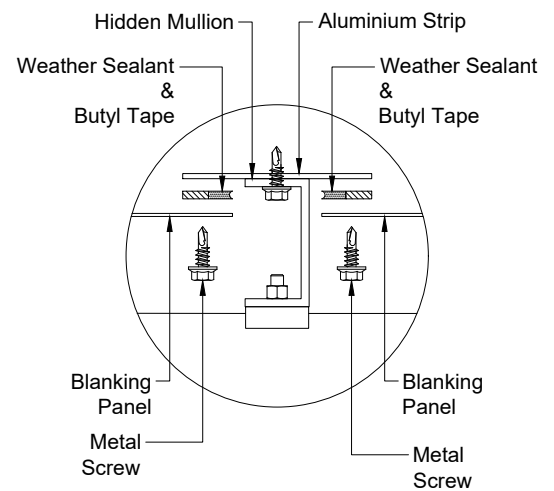

EXPLODED DETAIL

All dimensions in millimeters unless otherwise stated. Do not scale from the drawing.

Ventilation Louvres

A-3250 | Technical Datasheet

APPENDIX A - FREE AREA

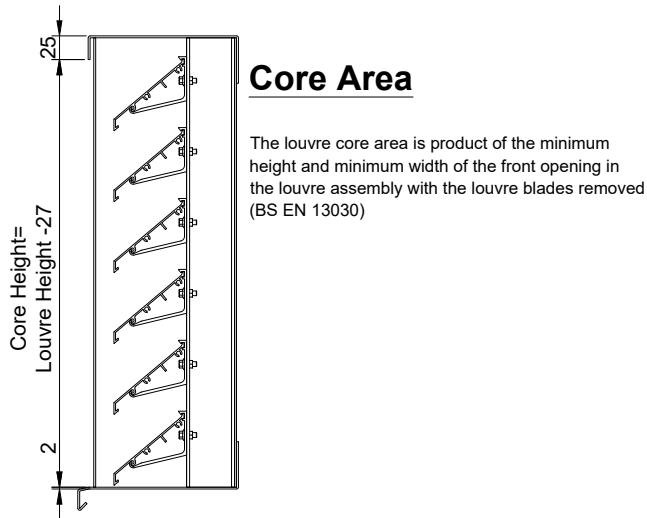

Free Area Between Blades

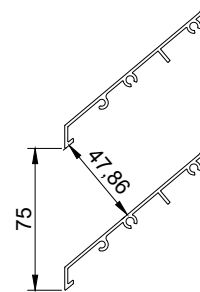

The percentage free area between the blades is calculated by taking the narrowest gap between the blades and dividing it by the blade pitch.

$$47.86/75 = 63.8\%$$

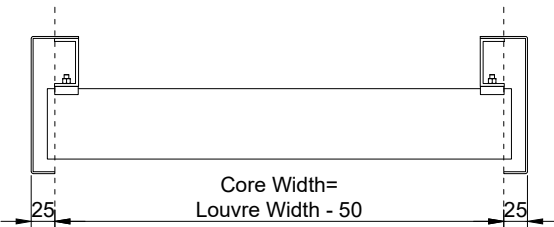

Free Area

Total free area is determined by multiplying the sum of the minimum distance between intermediate blades, top blade and head flashing, and bottom blade and cill pan, by the minimum distance between side flashings minus intermediate mullions width.

Percentage free area is calculated by dividing the total free area by the overall louvre size.

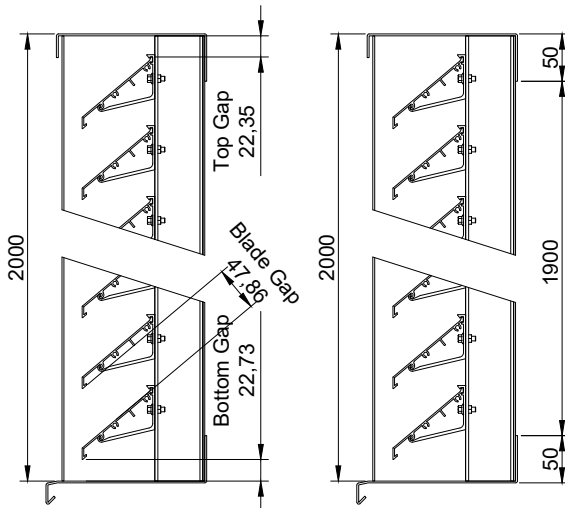

Example based on 2m x 2m louvre with flashings

- No. of blades - 26
- A - No. of gaps between blades - 25
- B - Top gap - 22.35mm
- C - Blade gap - 47.86mm
- D - Bottom gap - 22.73mm
- E - Width between jamba - 1900mm
- F - No. Intermediate Mullions - 1
- G - Mullion Width - 25.4mm

Total Free Area

$$(B + (C \times A) + D) \times (E - (F \times G))$$

$$(0.02235 + (0.04786 \times 25) + 0.02273) \times (1.900 - (1 \times 0.0254)) = 2.327\text{m}^2$$

Percentage Free Area

$$2.327/4 = 58.2\%$$

Approximate Free Area

Total Free Area

Opening at rear of louvre x percentage free area between blades

$$1.900 \times (1.900 - 0.0254) \times 63.8\% = 2.272\text{m}^2$$

Percentage Free Area

$$2.272/4 = 56.8\%$$

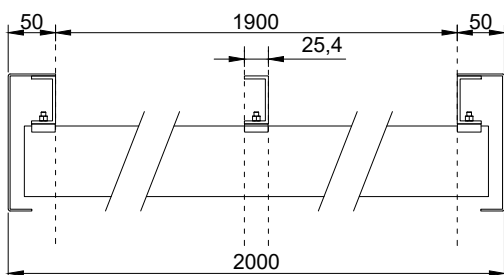

All dimensions in millimeters unless otherwise stated. Do not scale from the drawing.