

A-6177

Modular ventilation louvre offering excellent airflow performance, ideal for applications with permanent mechanical extract ventilation, such as data centres.



Features & Advantages

- Wide blade pitch maximises airflow performance
- Channels in blades and vertical sections help collect and drain away rainwater
- Visible mullions, to align with other façade elements; an invisible vertical joint detail can be achieved with hidden mullions, for a continuous look
- Delivered to site as pre-fabricated modules, for efficient installation

Applications

- Where a high free area / high airflow solution is required
- Where economy is the primary consideration
- In exhaust areas where a low pressure drop is needed, such as data centres

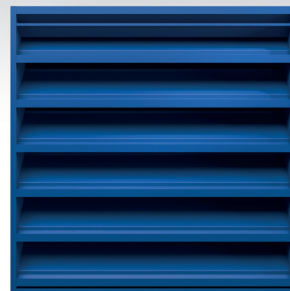

c-sgroup.co.uk/38274

A-6177

Standard Details

Section on elevation

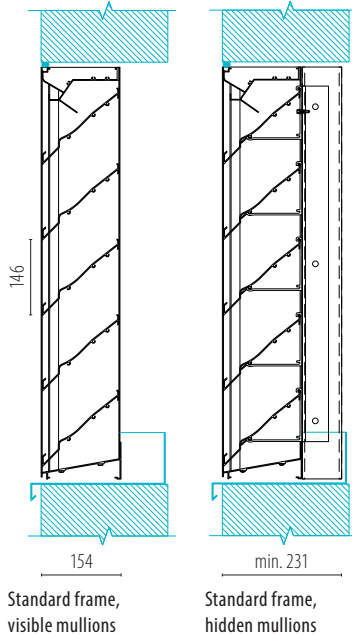

Plan view

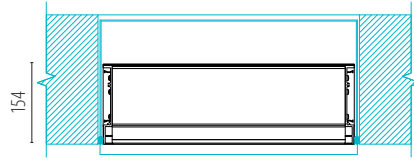

Standard frame

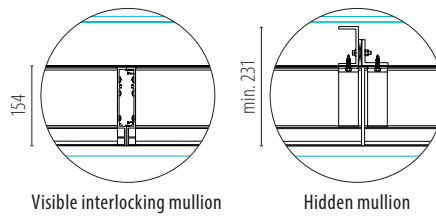

Module dimensions (based on 1.5 kPa wind load):

- Max height: 3600 mm*
- Max width: 3600 mm*

* For manual handling purposes max 80 kg per unit is recommended.

Custom widths can be manufactured, contact us to discuss your requirements.

Joint options:

- Horizontal: visible
- Vertical: visible (interlocking mullion) or invisible (hidden mullion)

For detailed drawings refer to Technical Datasheet.

Details include typical cill pan (size to project requirements).

Certification / Testing

- Tested in accordance with EN 13030 for Rain Defence and Airflow Performance.

For details view Performance Datasheet.

- Cradle to Cradle Certified Bronze

Certification applies to a range of colours and finishes.

For further information, visit: c-sgroup.co.uk/38764



Additional Security Options

- Blast Resistant Option

Designed to withstand up to an 86.87 kPa blast pressure at an impulse of 536.41 kPa-msec

Materials

- Aluminium alloy 6063-T6
- Nominal thickness: 2.06 mm for blades; 1.52 mm for heads; 2.03 mm for cills; 3.18 mm for jambs and mullions
- Aluminium components are manufactured with a minimum of 55% recycled content (mix of pre- and post-consumer scrap)
- Louvre weight 14 kg/m², based on a 2 m x 2 m module size

Finish Options



Warranty

- 2-year product warranty
- Up to 30-year finish warranty (powder-coated or anodised)

For Terms and Conditions visit: c-sgroup.co.uk/38509

Optional Extras

- Bird / vermin guards - galvanised weld mesh (standard) or expanded aluminium
- Insect mesh
- Blanking - single-skin plates or insulated panels
- Louvred doors and gates
- Dampers

For further information visit: c-sgroup.co.uk/26795